



# SCALA2



<http://qr.grundfos.com/i/scala2install>

be  
think  
innovate

**GRUNDFOS** 

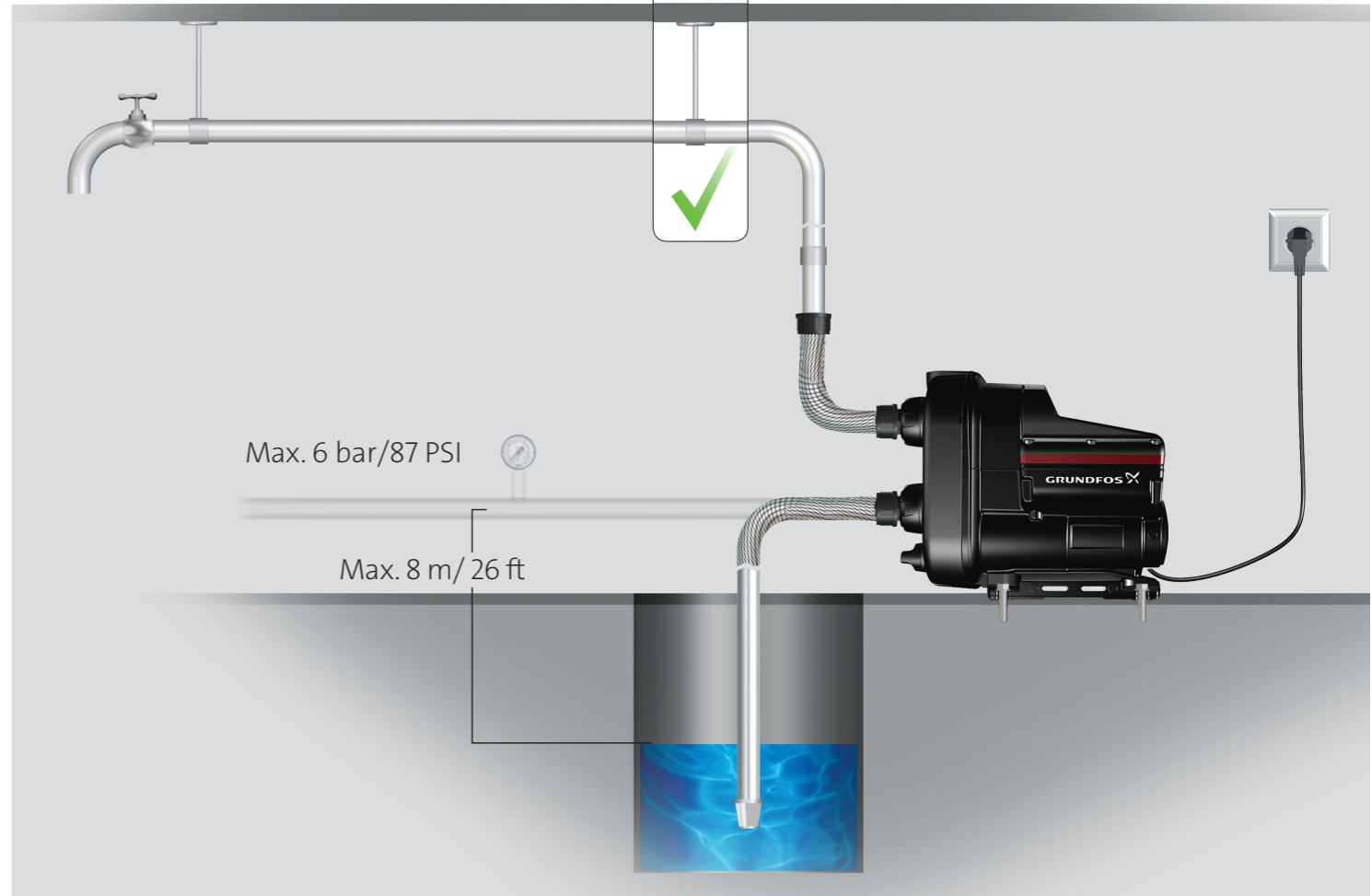
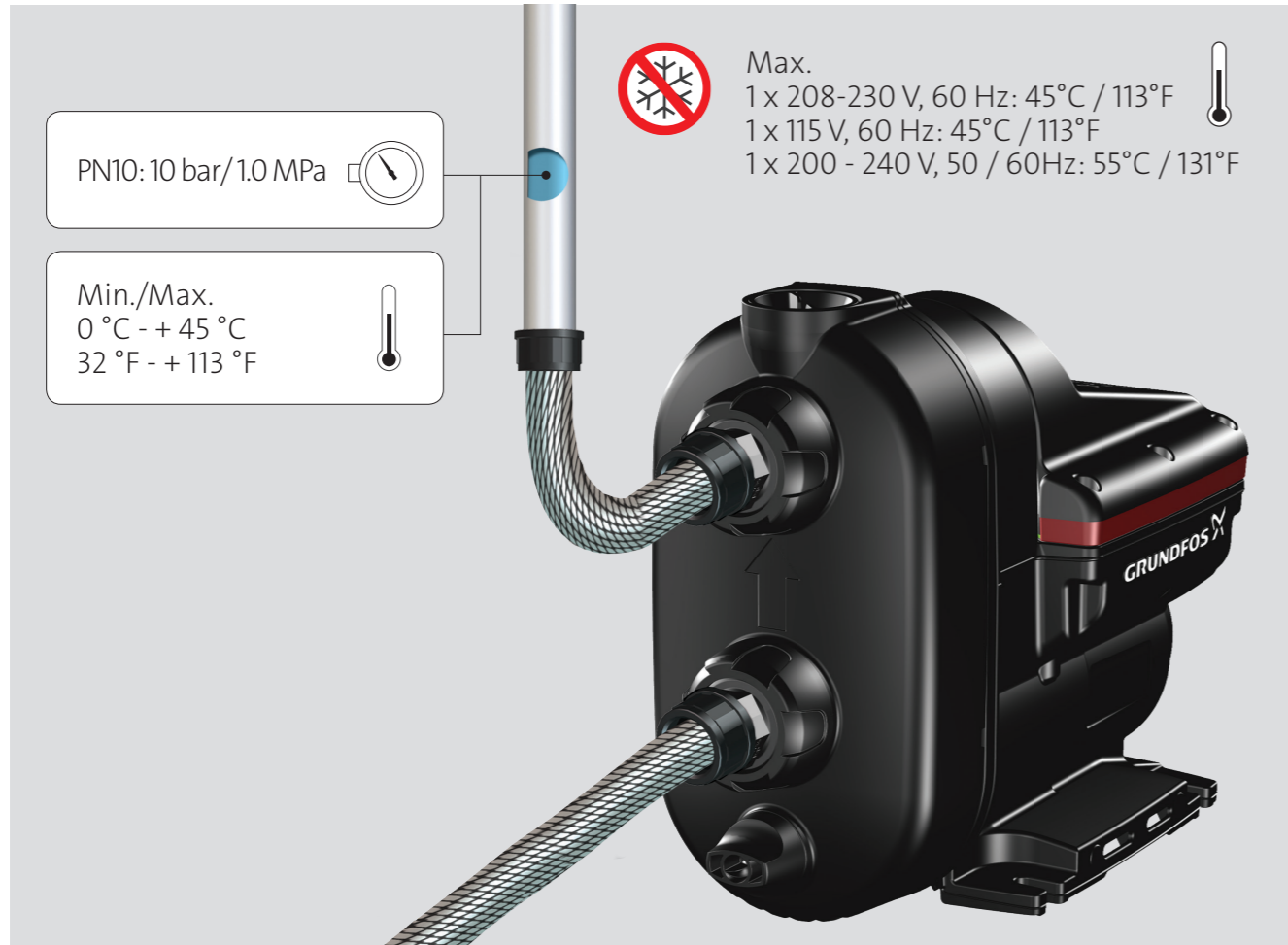
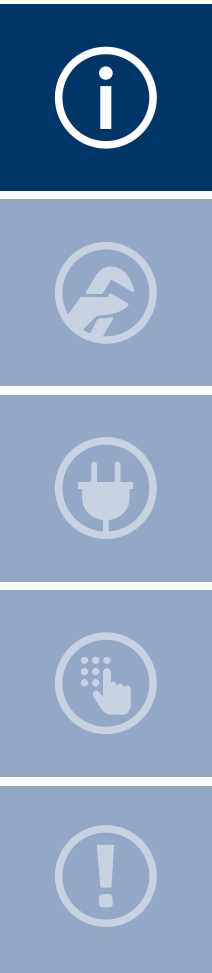

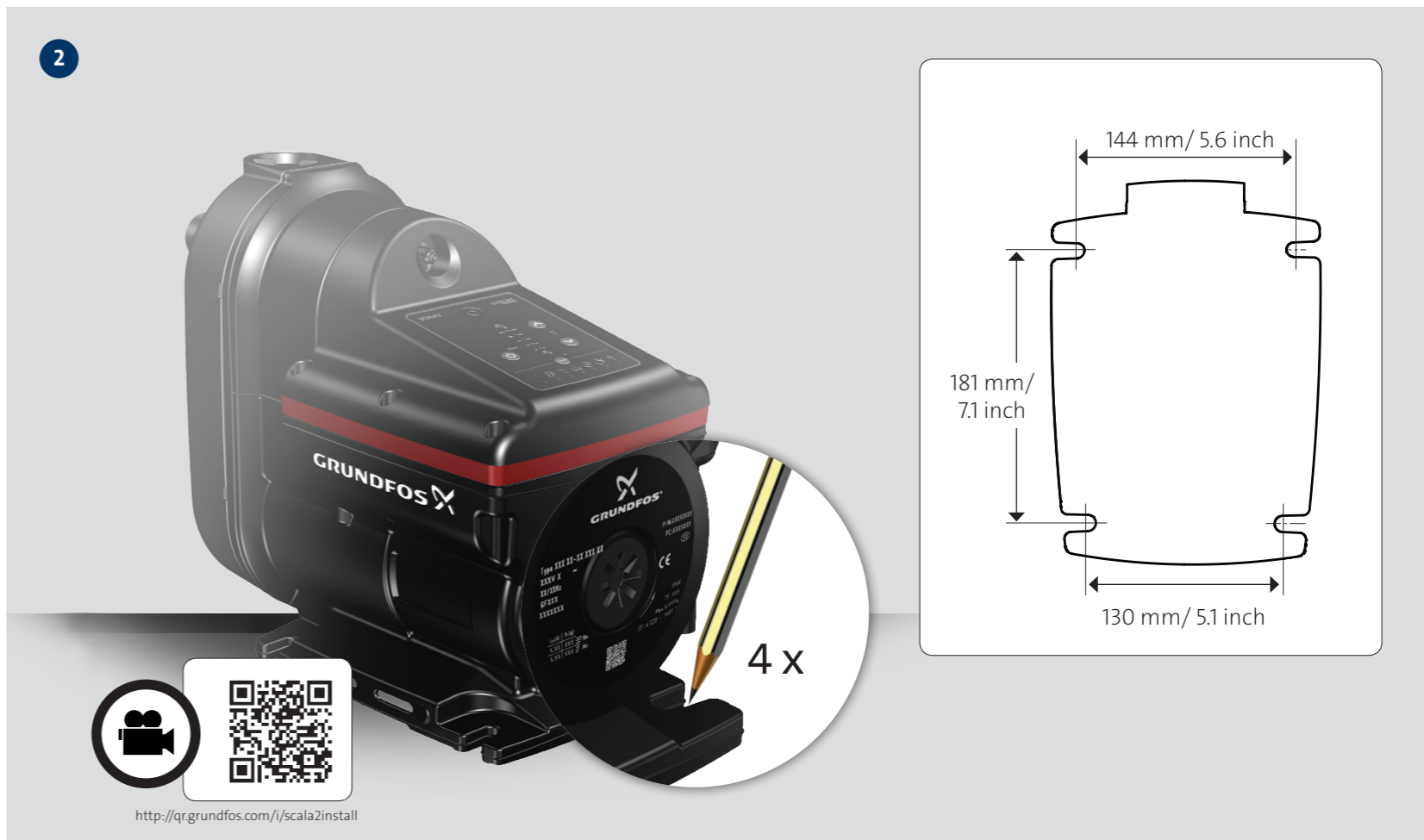
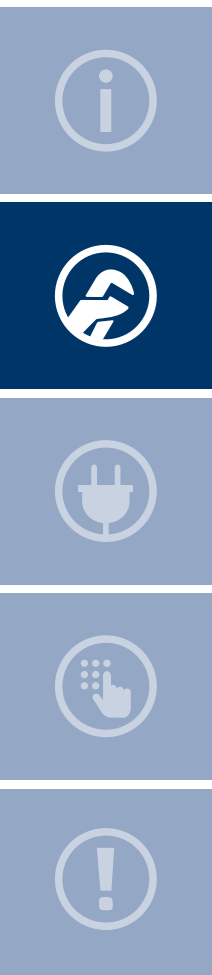

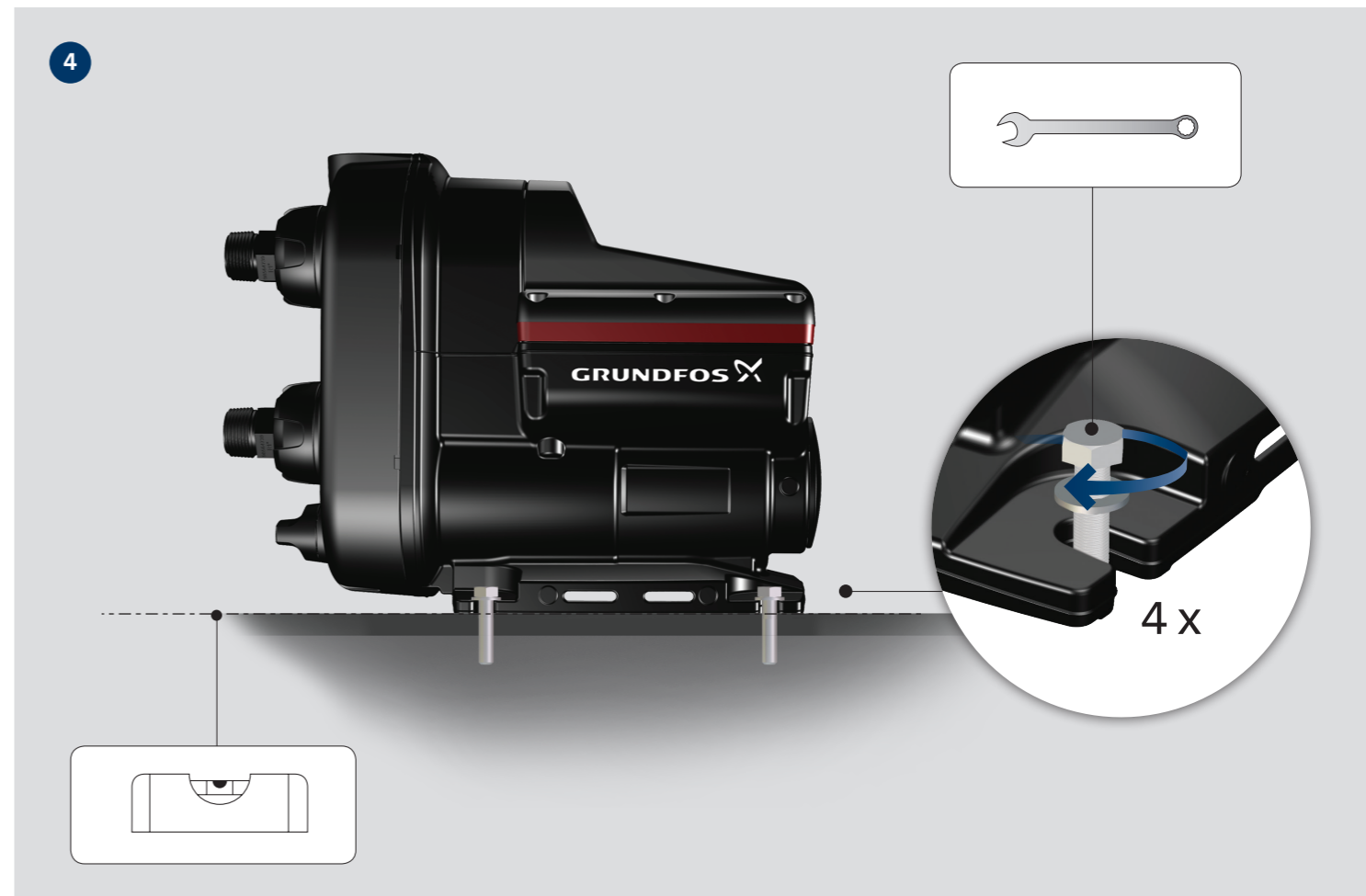
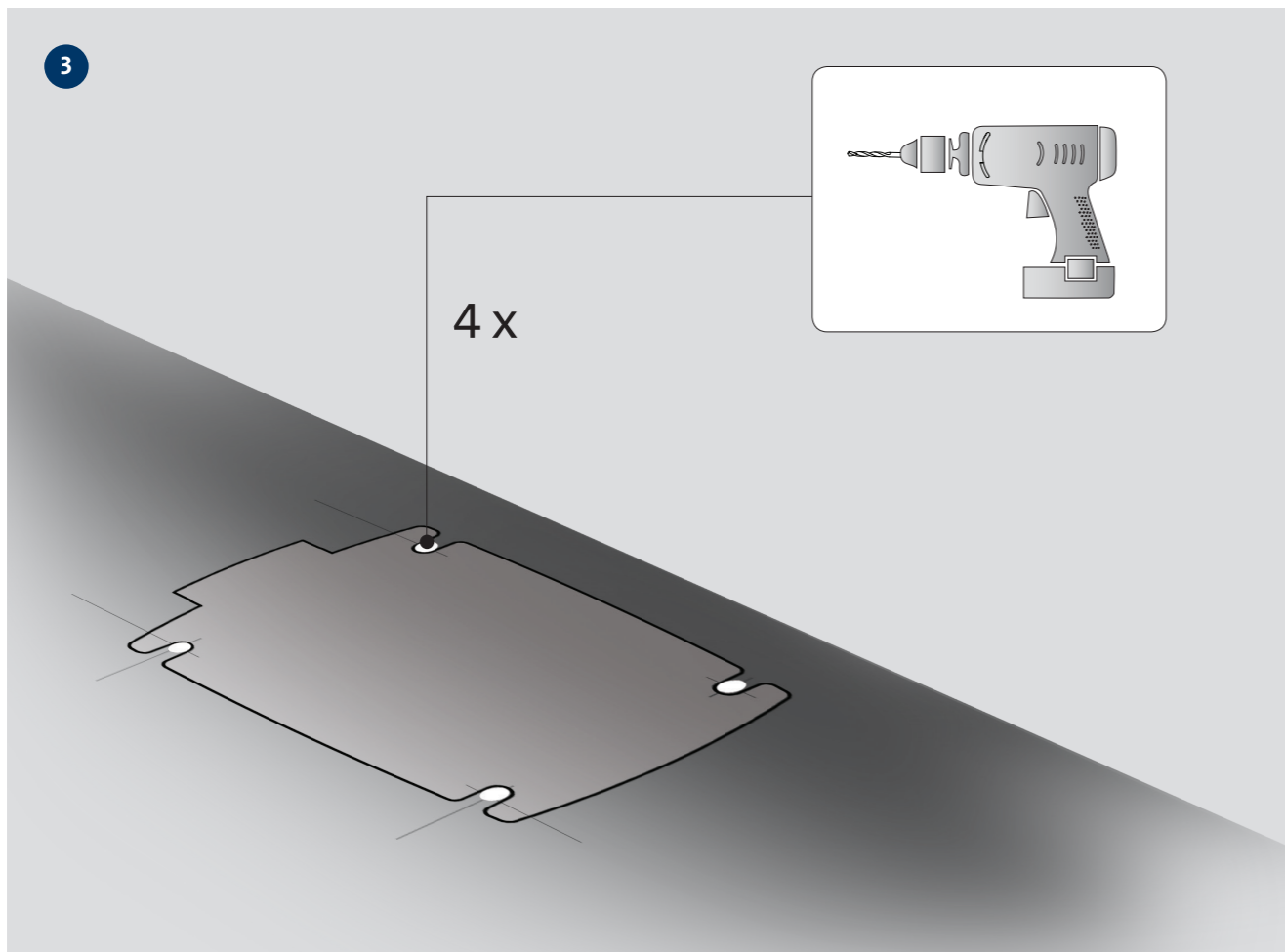
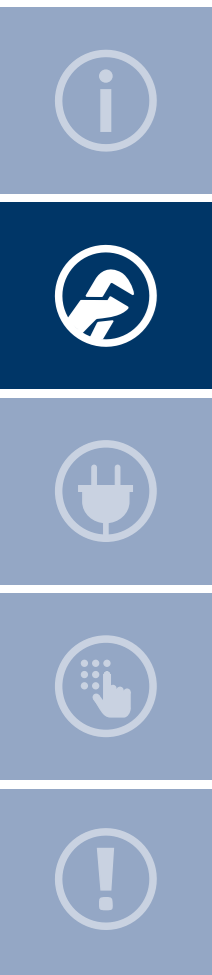

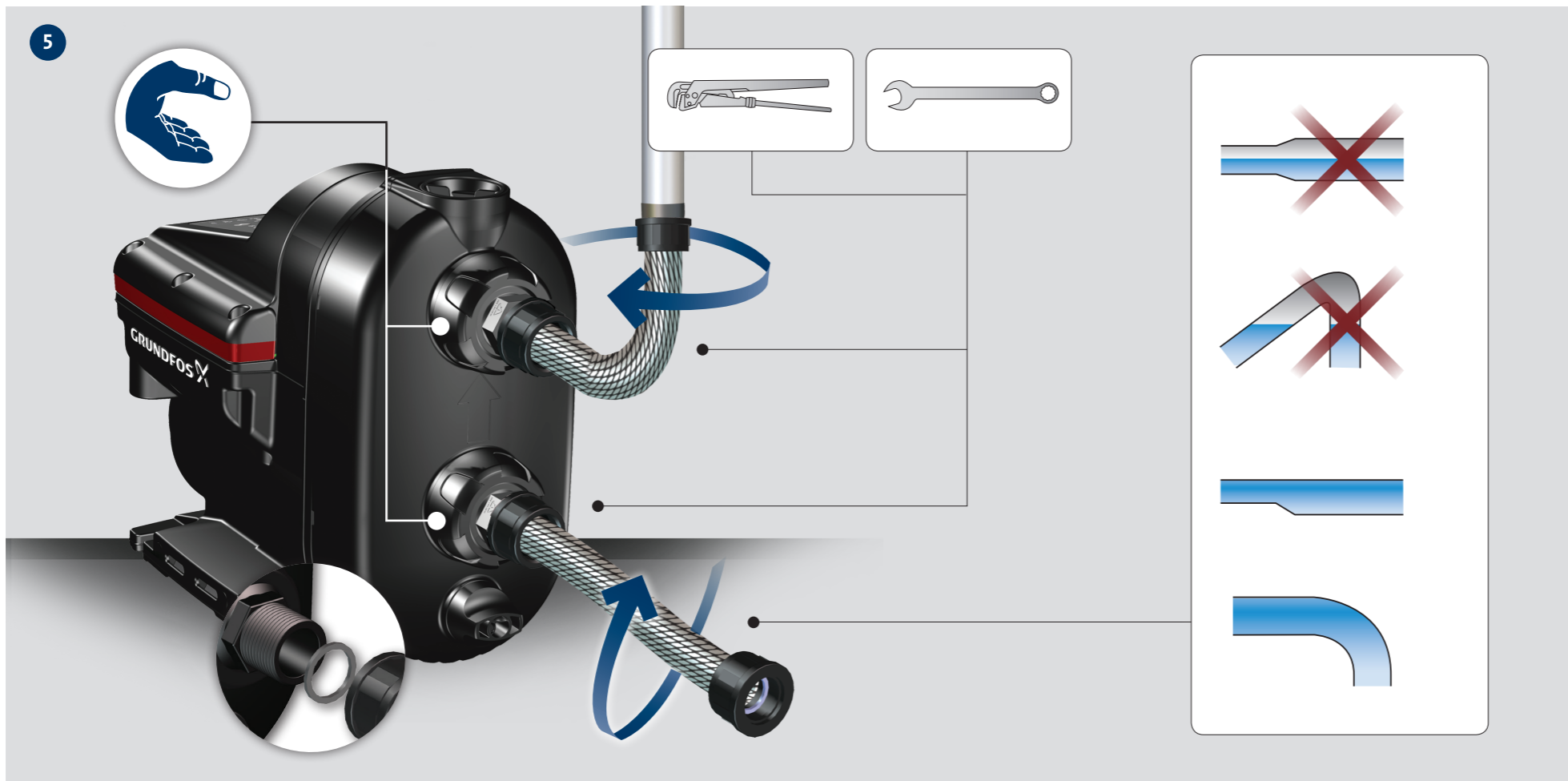
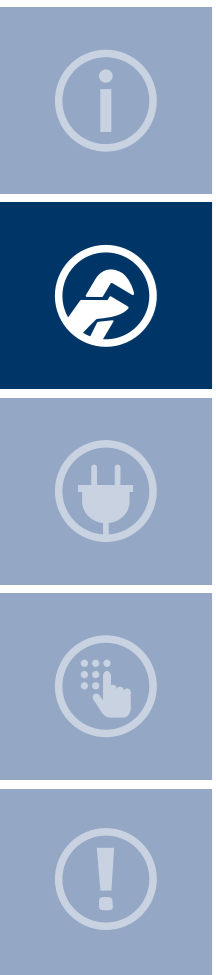

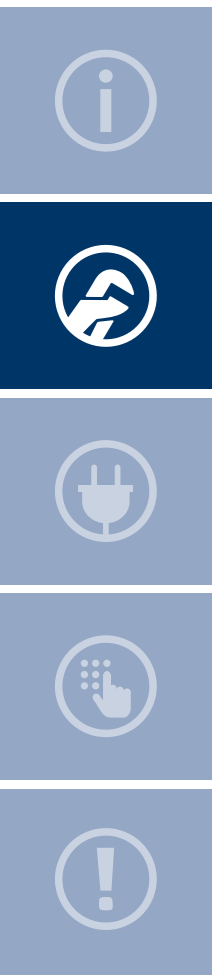

6

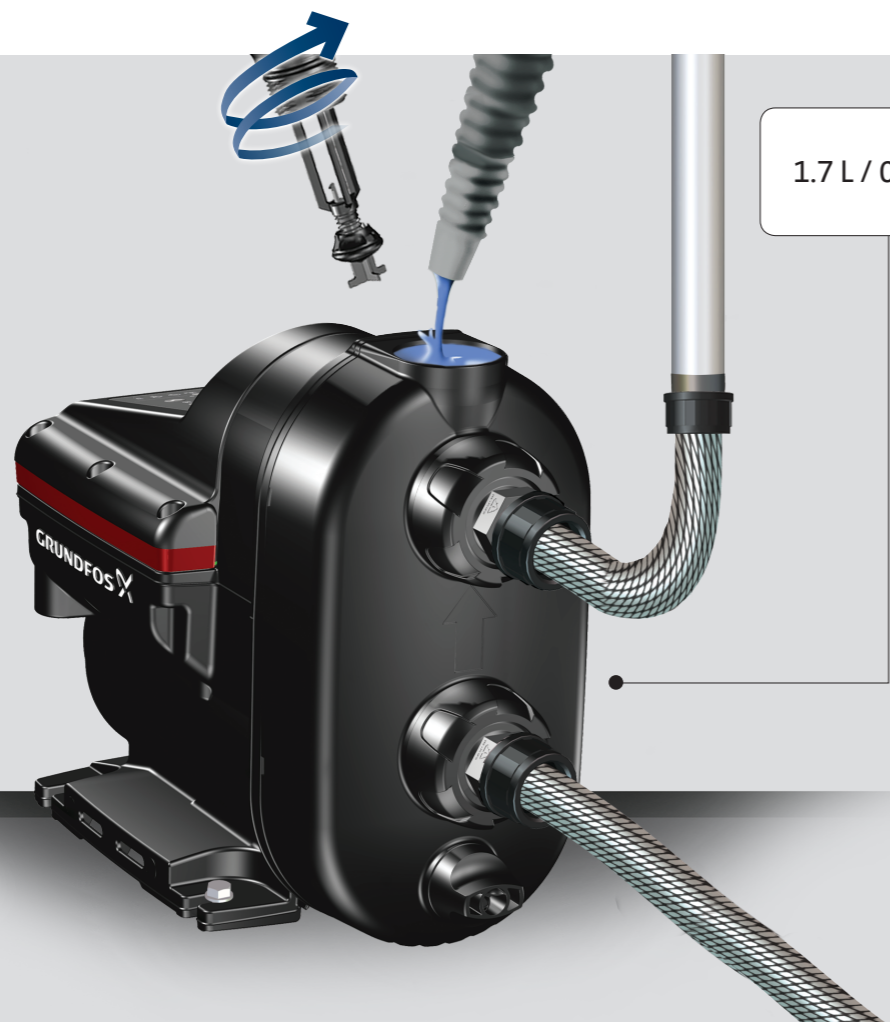

1.7 L / 0.45 gal



<http://qr.grundfos.com/i/scala2install>

7



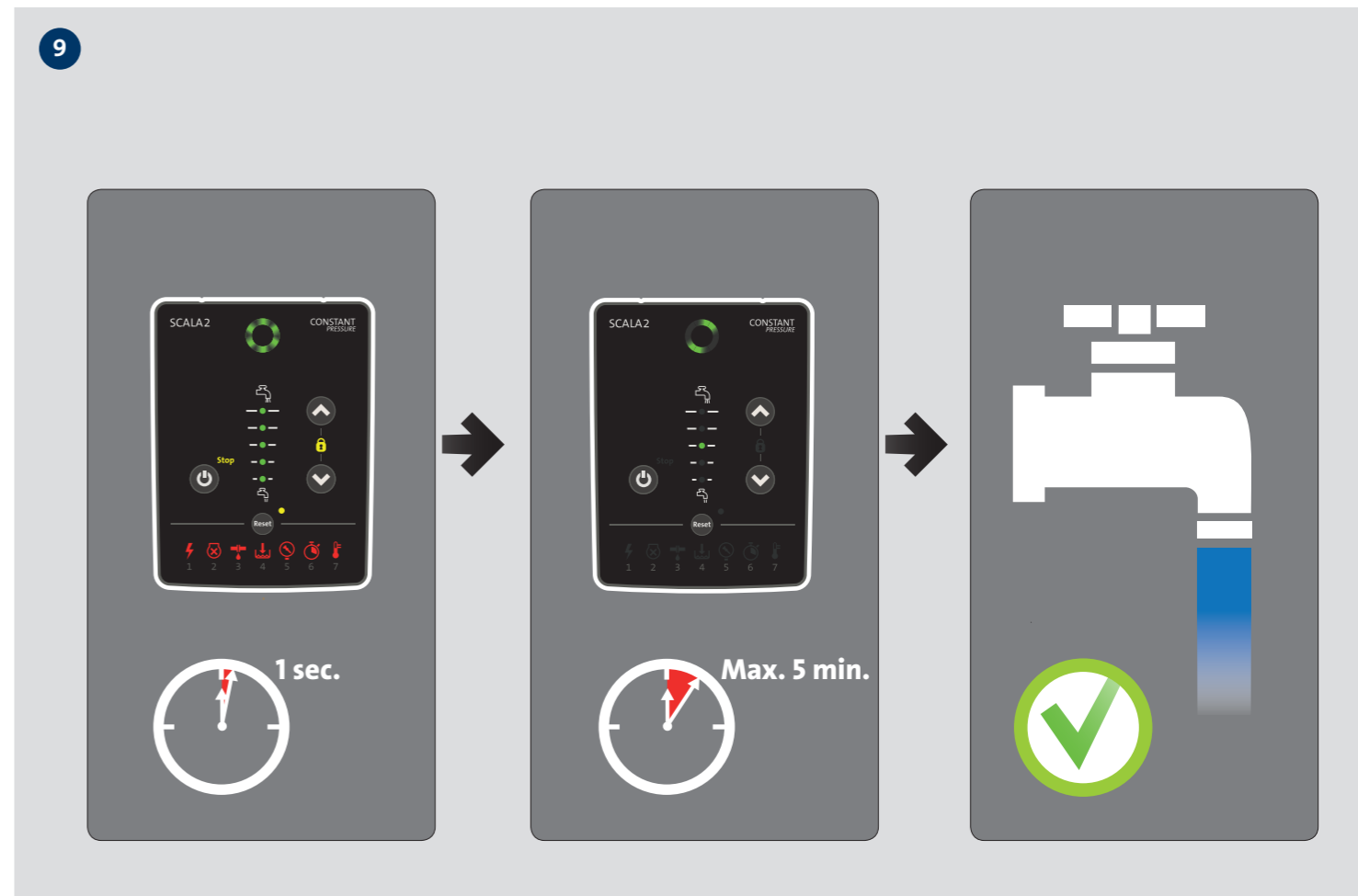
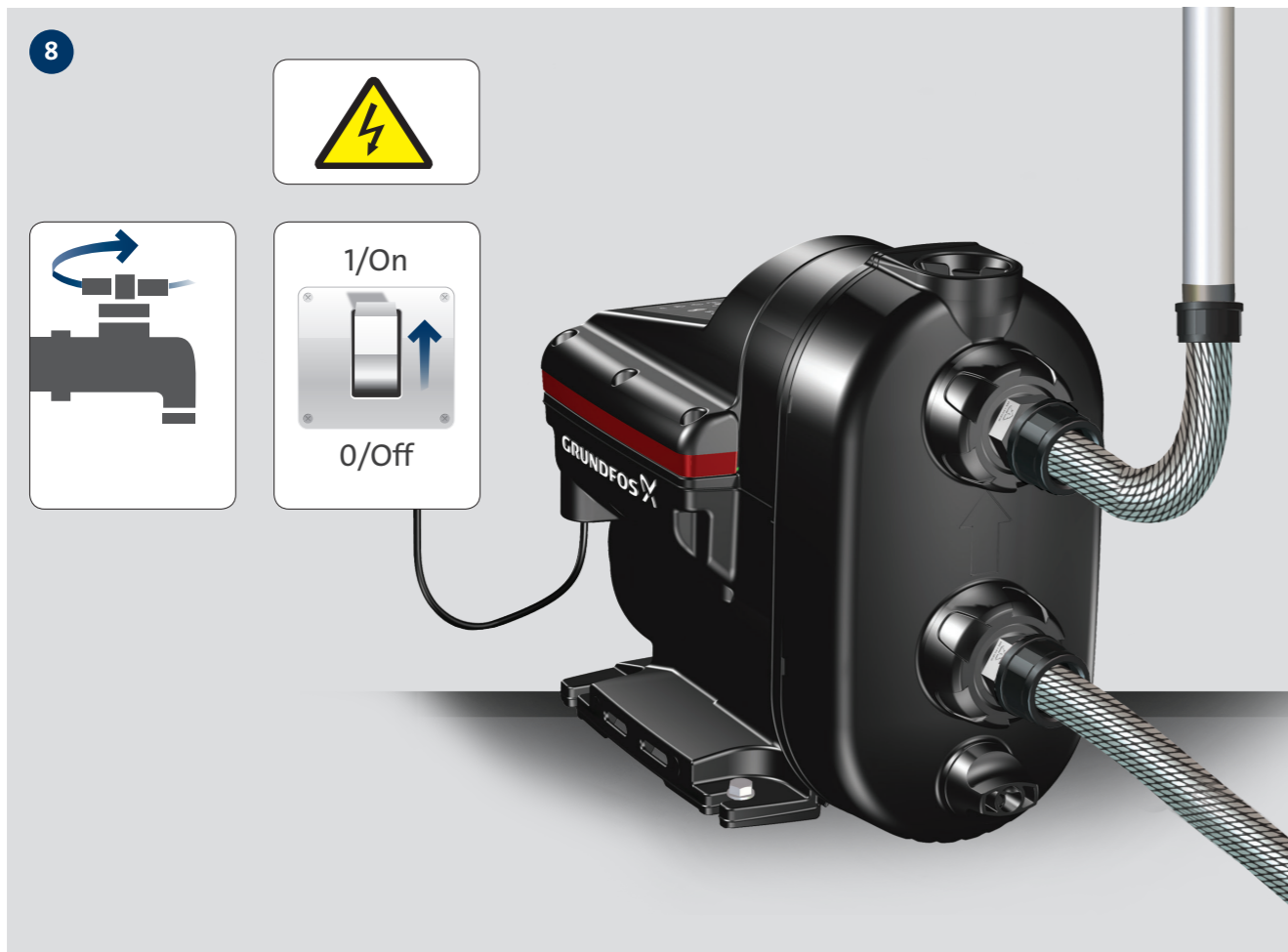
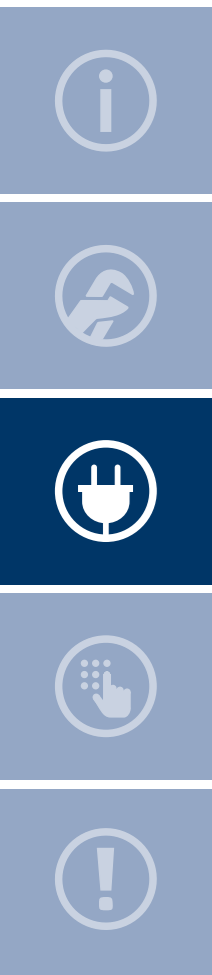

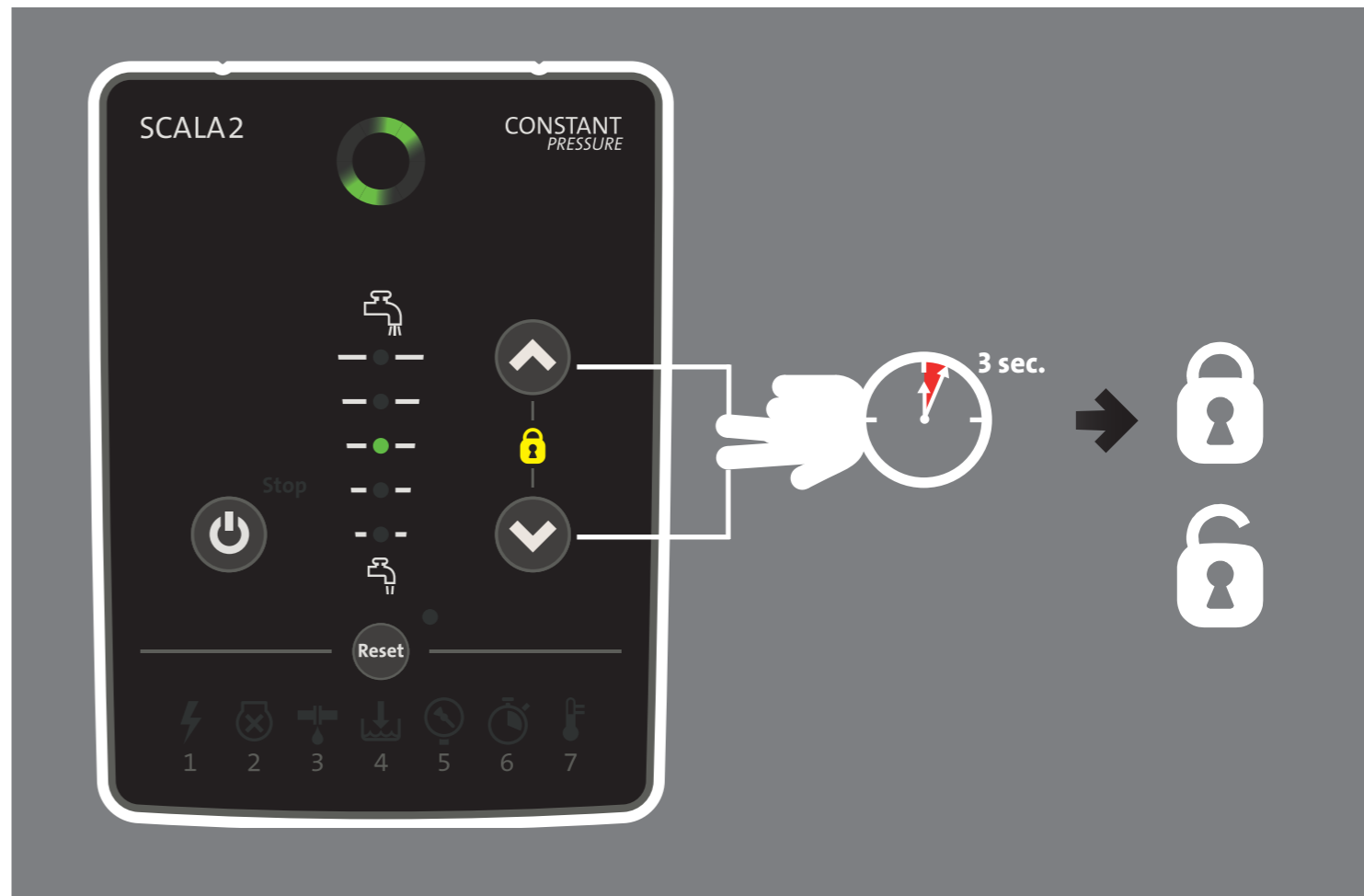
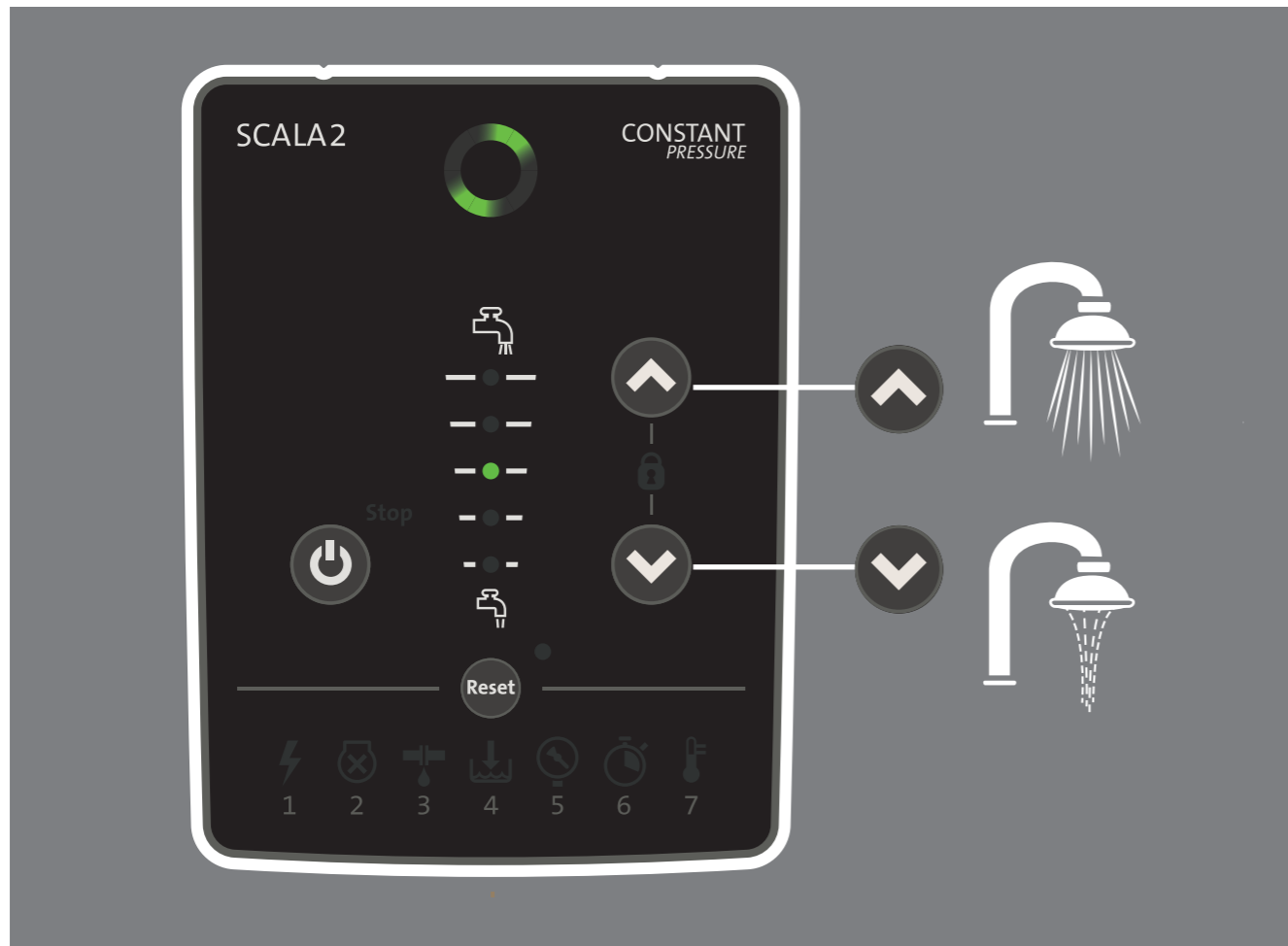
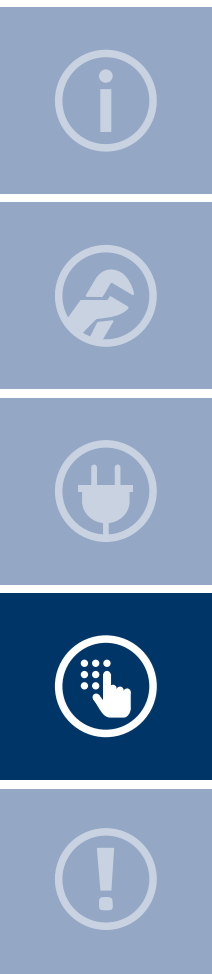



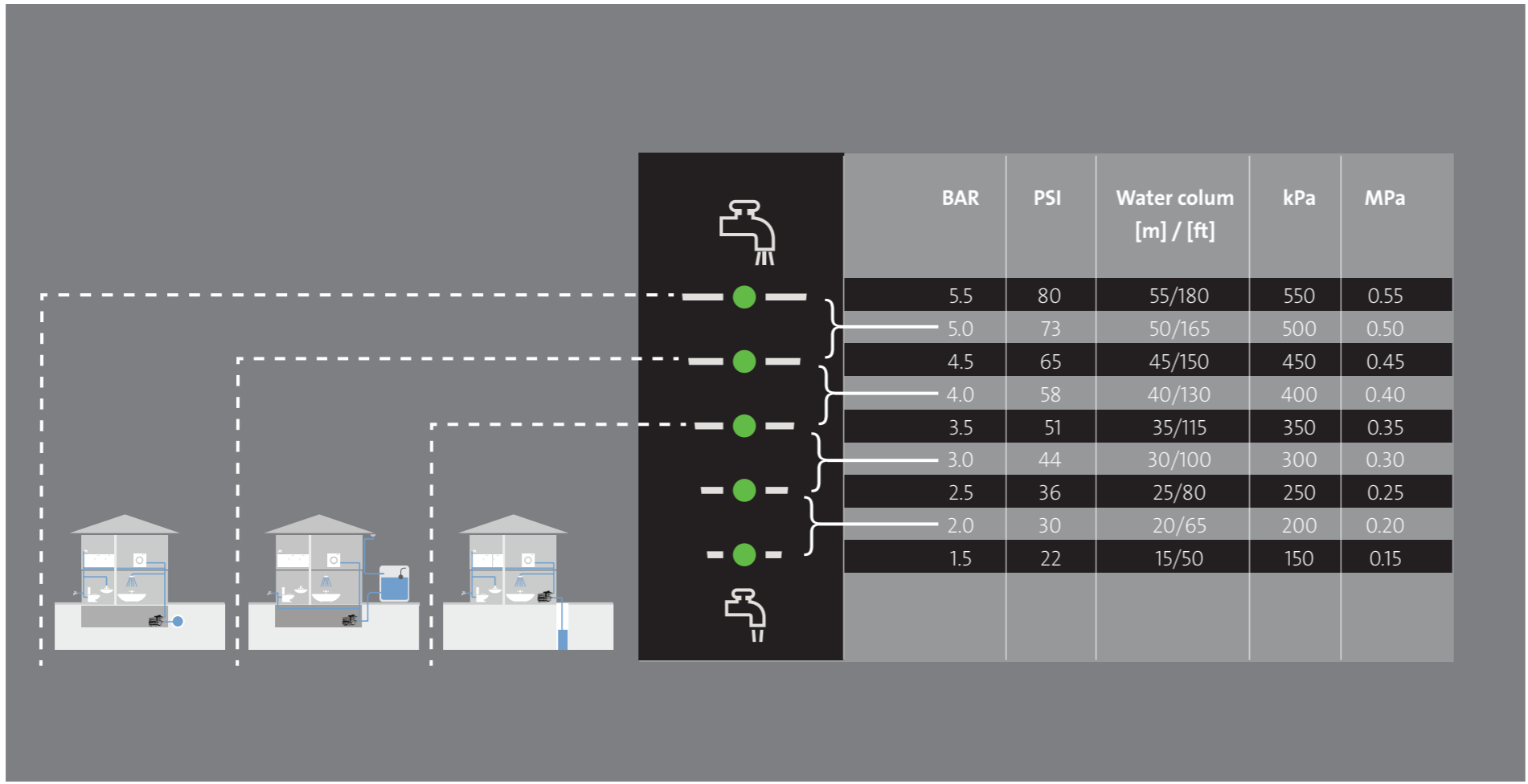
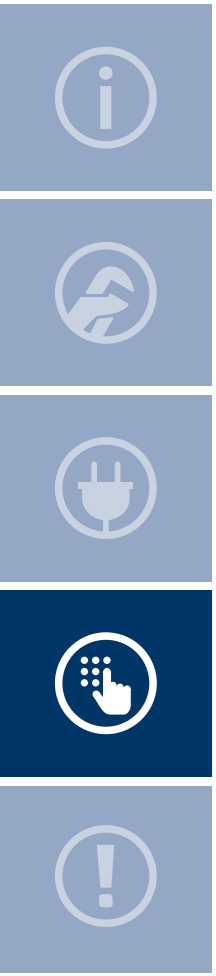

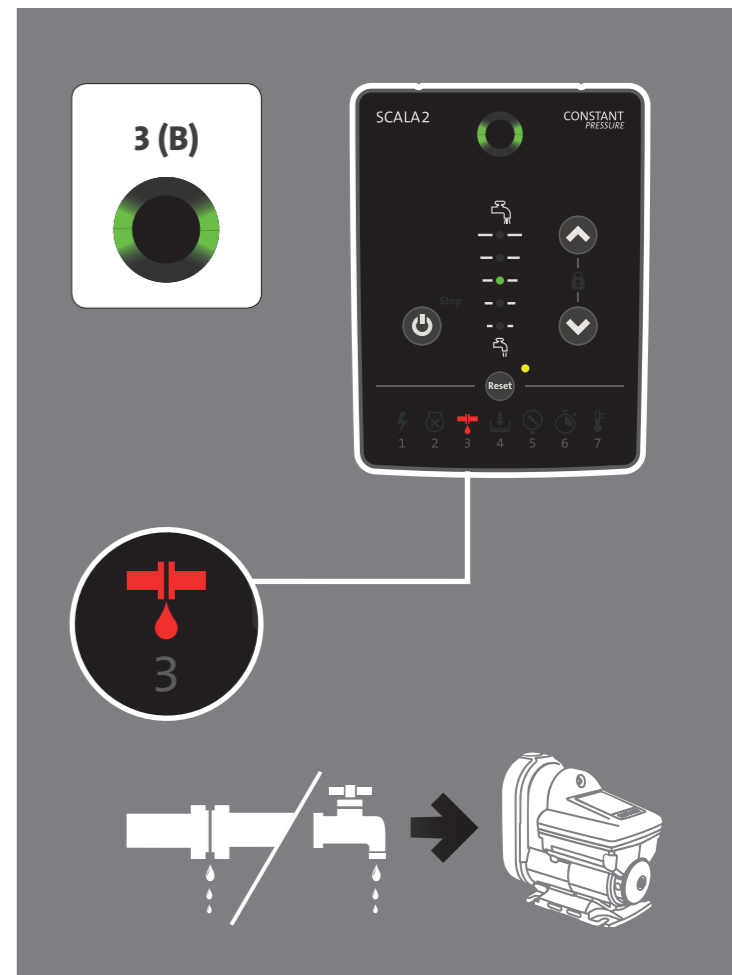
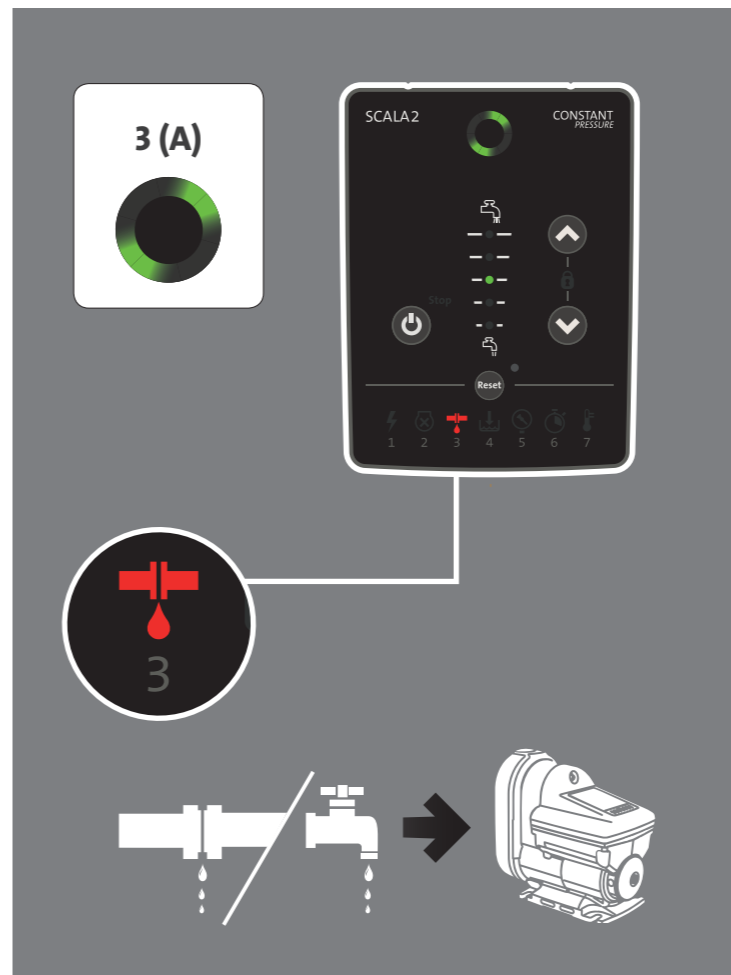
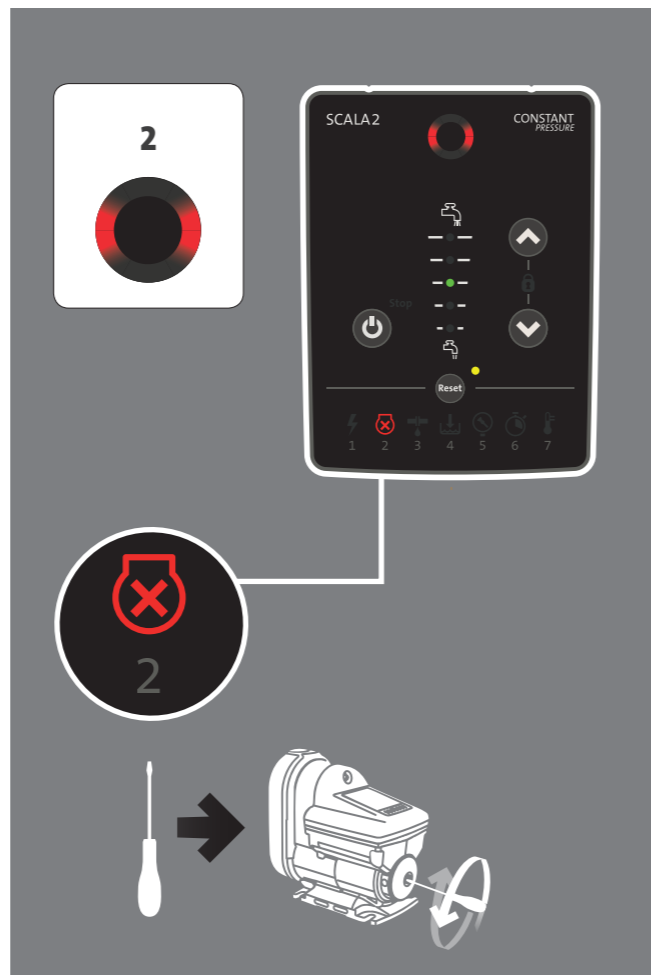
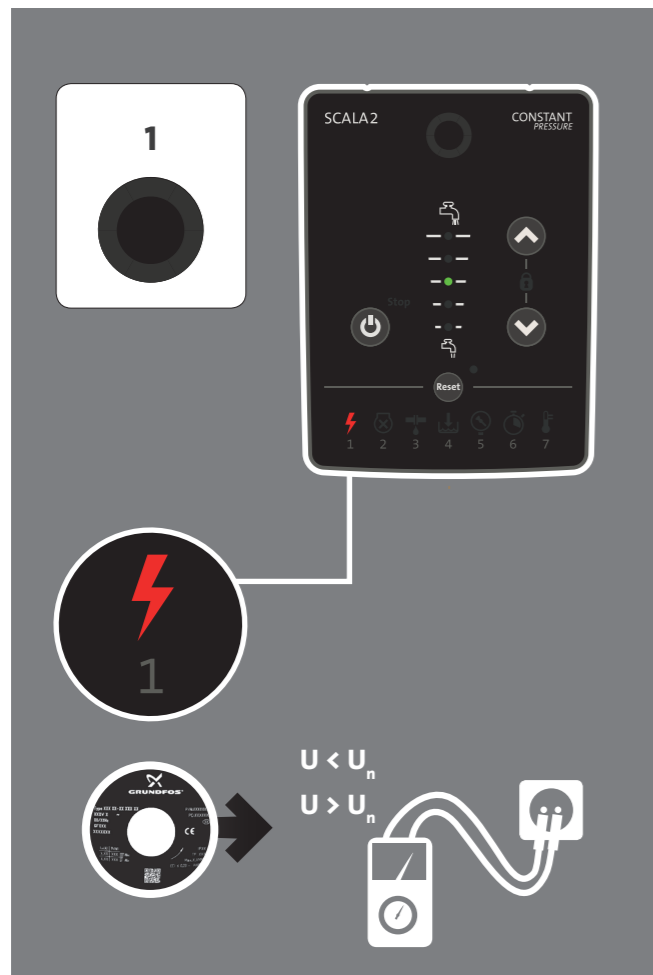
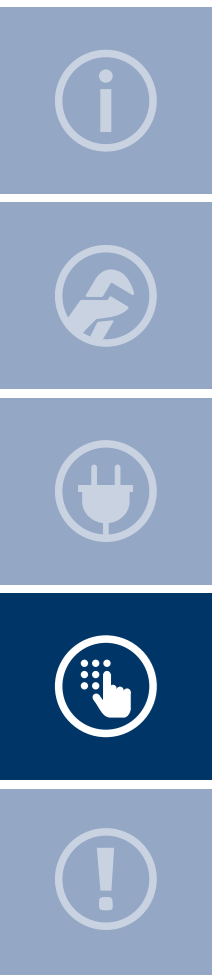

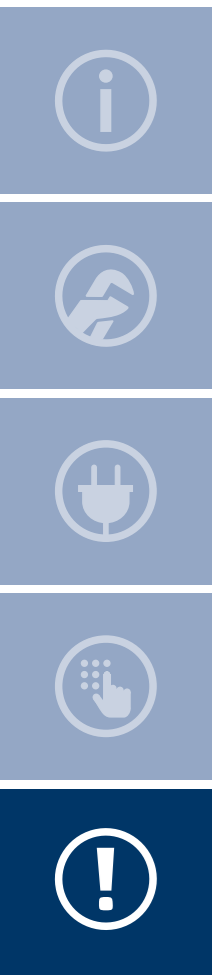

**4**

SCALA2 CONSTANT PRESSURE

Step

Reset

1 2 3 4 5 6 7

4

**5**

SCALA2 CONSTANT PRESSURE

Step

Reset

1 2 3 4 5 6 7

5

$p > p_{syst. max.}$

$Pset > Hmax$

**6**

SCALA2 CONSTANT PRESSURE

Step

Reset

1 2 3 4 5 6 7

6

0.5 hr.

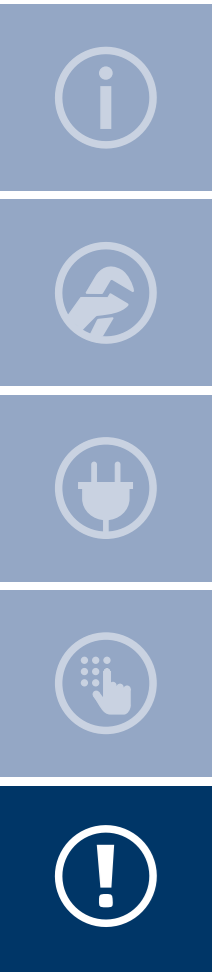

**7 (A)**

SCALA2 CONSTANT PRESSURE

7

22

**7 (B)**

SCALA2 CONSTANT PRESSURE

7

23

1 2 3 4 5 6 7

[net.grundfos.com/qr/i/98880508](https://net.grundfos.com/qr/i/98880508)

23

be think innovate

---

98501666 0416

ECM: 1183347

**GRUNDFOS Holding A/S**  
Poul Due Jensens Vej 7  
DK-8850 Bjerringbro  
Tel: +45 87 50 14 00  
[www.grundfos.com](http://www.grundfos.com)

**GRUNDFOS** 

The name Grundfos, the Grundfos logo, and be think innovate are registered trademarks owned by Grundfos Holding A/S or Grundfos A/S, Denmark. All rights reserved worldwide.